

Installation Instructions LED Downlight

Product SCDLS

Product Specification	
Part Code	SCDLS
Colour Temp	3000K/4000K/5700K
Lumen Output	750lm-670lm
IP Rating	IP44 (from front only)
Power	8W
CRI	>80
Voltage Rating	220V-240V~ 50/60Hz
LED Lamp Life (L70)	30,000 Hrs
Dimmable	Yes
Operating Temp	-10°C to 40°C
Electrical Class	Class II
Ambient	(IC-4@ ta 25°C)

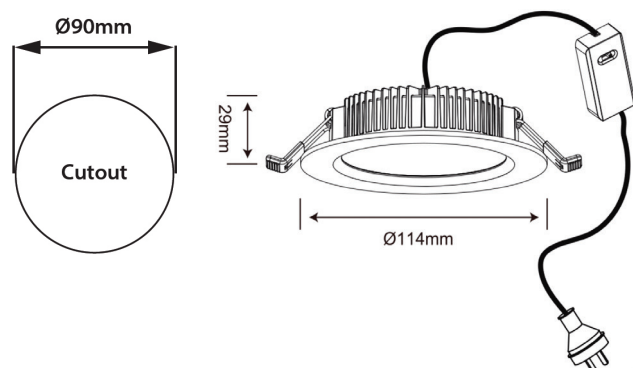

Installation Method

Read instructions and check you have all the tools and accessories to complete the installation correctly.

1. Isolate the mains power supply before starting installation.
2. Cut 90mm aperture in the ceiling.
3. With the power turned off, make electrical connections. Pass mains plug and driver through ceiling aperture and plug into socket in the ceiling place.
4. Holding the luminaire level with front facing down, push the spring clips upwards and fit luminaire into the cut-out. Ensure the supply cables are dressed away from the fixings and ensure the luminaire is pressed carefully into the ceiling.
5. When the luminaire is half way into the ceiling, release the springs. The luminaire should then hold itself firm. Press luminaire firmly into place. The product should be installed flush to the ceiling surface.
6. Restore the power supply, switch on and test for the correct operation.

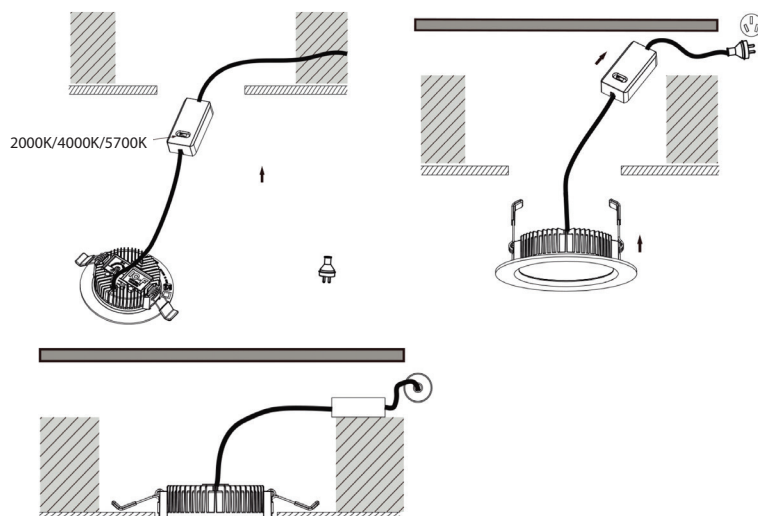

Clearances

Can be Covered and Abutted

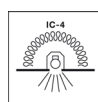

IC-4 Rated

These luminaires comply with AS/NZS 69598.2.2.

They are approved to not exceed 90°C when side abutted or covered with insulation. Building insulation used to abut and cover the luminaire must be a type that can maintain its dimensions and structural integrity when exposed to maximum surface temperature of the class luminaire, being 90°C and must also withstand a 30sec needle flame test carried out in accordance with AS/NZS 60695.11.5 with the flame applied to all surfaces of the sample.

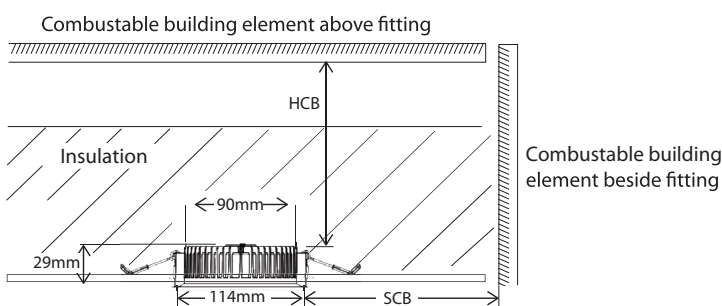

Risk of Fire

Required clearance from structural members and building elements

HCB: 0mm	MIC: 0mm
SCB: 0mm	SCI: 0mm

HCB = Minimum distance between the top of the recessed luminaire and any building element above it.

MIC = Minimum distance between the top of the recessed luminaire and the building insulation above it.

SCB = Minimum distance between the side of the recessed luminaire and any building element.

SCI = Minimum distance between the recessed luminaire and any building insulation.



Installation Instructions LED Downlight

Dimming

The Scorpion Downlights have been designed for optimum performance with our Dimpala range of dimmers.

Dimpala Product Codes

DIMR - Dimpala Universal Dimmer

DIMPR - Dimpala Push Rotary Dimmer (Glow)

DIMPRX - Dimpala Push Rotary Dimmer (No Glow)

Please refer to our Website or Catalogue for further detail and accessories

Note: In some regions a slight flicker may occur when the luminaire is dimmed. This could be due to power line signals sent by electricity supply utilities. This effect is not a malfunction of the luminaire or dimmer but could be a result of local power supply changes. If this occurs at any stage adjusting the dimmer back to maximum output should minimise the effect.

Important Information

It is recommended that luminaires be installed and fitted by a qualified electrician, ensuring the installation complies to the current building regulations. These products are designed for connection to a 220-240V~50Hz supply.

Trader will not accept responsibility for any claims arising from incorrect installation or application.

If cleaning is necessary, ensure product is switched off and only wipe the accessible lens and shells with a damp cloth and dry off using a dry lint free cloth.

Warning

Caution no user serviceable parts contained, risk of electric shock if dismantled. Cutting cables or damaging components will void warranty.

Check whether the product has been damaged in transport. Do not operate or install any product which appears damaged in any way. Return the complete product to place of purchase for inspection or replacement.

Warranty

This product has been manufactured to the highest quality standards. This product is warranted to the original purchaser and is not transferable.



The product is guaranteed to be free from defects in workmanship and parts for a period of 5 Years from the date of purchase, for full warranty detail please refer to www.gsme.com.au

GSM Electrical (Australia) Pty Ltd
Level 2 142-144 Fullarton Road, Rose Park SA, 5067
P: 1300 301 838 E: service@gsme.com.au
www.gsme.com.au