

## Data Sheet

### Features

- Fits standard Australian wall boxes and mounting accessories that use 84mm mounting centres.
- Combination head screws with a 6mm bore to suit 4 x 2.5mm<sup>2</sup> cable (screws backed out for easier installation of cabling).
- Screw caps included to cover mounting screws.
- LED indicator lights up when switched on.
- Soft touch button activation.
- Covers, plates and buttons are made from UV stabilised polycarbonate to avoid discolouring.
- Silverfish antenna technology.
- Bluetooth mesh connectivity with each device acting as a repeater.
- 2 year warranty.
- Real time energy use in watts & dollars.
- Automatic schedules inbuilt.
- Auto off timer (double press to ignore).
- Power outage recovery.
- Power lock.
- Individual socket control.
- Night light on/off and auto dim.
- High energy use alert.
- Voice control with your favourite voice assistant.\*

**Plus more features with the latest software version.**  
Visit [www.zimi.life](http://www.zimi.life)

### Specifications

Product Code	Colour	Description	Max Load Rating	Line Voltage Freq.
PMPP	White	Powermesh Power Point Switched 2 Gang	10A @ 250V~ 2500W	50Hz Nominal
PMPPBK	Black			

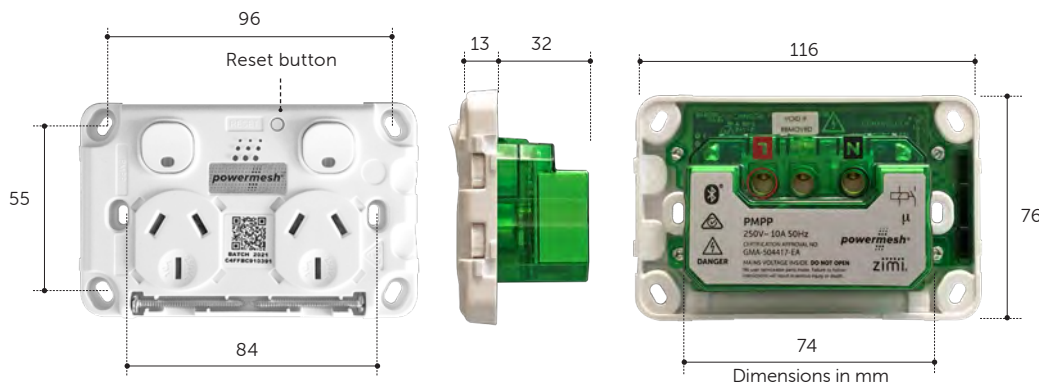

#### Cleaning Guidelines

Ensure that switches are turned off before cleaning. Only clean the surfaces with a damp or dry cloth.

#### DO NOT

- x spray anything directly on to electrical switches or power point sockets
- x use cleaning sprays or harsh chemical cleaners
- x use an abrasive cloth
- x wash the cover plates in hot water.



PMPP



PMPPBK

**Standards Approval:**  
AS/NZS3112 & AS/NZS CISPR15

**Certification Number:**  
GMA-510336-EA



#### Download Zimi

Scan the code with your phone camera to download.



#### Zimi Cloud Connect \*

Control all your Powermesh devices anywhere in the world via your Wi-Fi Internet.



14 Millennium Circuit, Helensvale,  
QLD 4212 Australia. [www.zimi.life](http://www.zimi.life)

Need help?  
<https://support.zimi.life>

# Fan Controller with Light Switch



## Data Sheet

### Features

- Fits standard Australian wall boxes and mounting accessories that use 84mm mounting centres.
- Switch terminals have 4mm bore to suit 1.5mm<sup>2</sup> cable.
- Screw caps included to cover mounting screws.
- LED indicator displays on/off state, and fan speed.
- Sliding touch control for fan speed.
- Touch control for light (room or fan light).
- Covers and plates are made from UV stabilised polycarbonate to avoid discolouring.
- Silverfish antenna technology.
- Bluetooth mesh connectivity with each device acting as a repeater.
- 2 year warranty.
- Real time energy use in watts & dollars.
- Automatic schedules inbuilt.
- Auto off timer (double press to ignore).
- Power outage recovery.
- Night light on/off and auto dim.
- Speed Sense technology changes the fan speed with room temperature.
- Behaviour Link other devices.
- Voice control with your favourite voice assistant.\*

**Plus more features with the latest software version.  
Visit [www.zimi.life](http://www.zimi.life)**

### Specifications

Product Code	Colour	Description	
PMFC	White	Powermesh Fan Controller with Light Switch	<ul style="list-style-type: none"><li>• <b>Line voltage frequency:</b> 50Hz Nominal</li><li>• <b>7 speed capacitor control:</b> 1.1~3.3μF + full speed, suitable for most AC fans.</li><li>• <b>Fan load:</b> 120 watts maximum @ 240V~</li><li>• <b>Light load:</b> 250 watts maximum @ 240V~</li></ul>
	Black (skin only)		

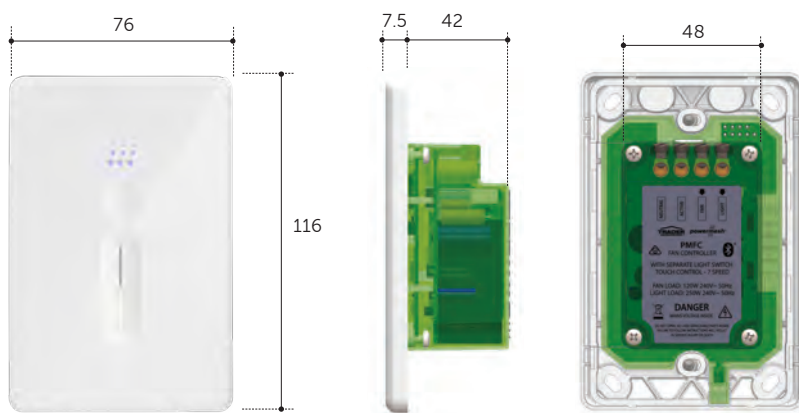

Dimensions in mm

#### Cleaning Guidelines

Ensure that switches are turned off before cleaning. Only clean the surfaces with a damp or dry cloth.

#### DO NOT

- x spray anything directly on to electrical switches or power point sockets
- x use cleaning sprays or harsh chemical cleaners
- x use an abrasive cloth
- x wash the cover plates in hot water.



PMFC



PMFCCBK

Black skin only.

#### Standards Approval:

AS/NZ60669.2.1 & AS/NZS CISPR15

#### Certification Number:

GMA-506666-EA



#### Download Zimi

Scan the code with your phone camera to download.



#### Zimi Cloud Connect \*

Control all your Powermesh devices anywhere in the world via your Wi-Fi Internet.



14 Millennium Circuit, Helensvale,  
QLD 4212 Australia. [www.zimi.life](http://www.zimi.life)

Need help?  
<https://support.zimi.life>

Powermesh products must be installed by a qualified electrician. Zimi requires a compatible (Android, iOS) mobile device, minimum OS requirements are available at [www.zimi.life](http://www.zimi.life). Availability and performance of certain features are service, device and network-dependent and may not be available in all areas; subscription(s) may be required, and additional terms, conditions and/or charges may apply. All features, functionality and other product specifications are subject to change without notice or obligation. Powermesh products are optimised for the use with the Zimi App. The Bluetooth word mark and logos are registered trademarks owned by the Bluetooth SIG, Inc. iOS is a trademark or registered trademark of Cisco Inc. Zimi and Powermesh and their respective logos are registered trademarks of Zimi Ltd. Google and Google Play are trademarks of Google LLC. Amazon, Alexa, and all related logos are trademarks of Amazon.com, Inc. or its affiliates. Apple, the Apple logo, Apple Watch and iPhone are trademarks of Apple Inc., registered in the U.S. and other countries. App Store is a service mark of Apple Inc., registered in the U.S. and other countries. Copyright © 2021 Zimi Ltd. All rights reserved.

# Light Dimmer



## Data Sheet

### Features

- Fits standard Australian wall boxes and mounting accessories that use 84mm mounting centres.
- Switch terminals have 4mm bore to suit 1.5mm<sup>2</sup> cable.
- Screw caps included to cover mounting screws.
- Mini indicator displays the brightness level.
- Trailing edge dimmer.
- Supports 2 wire (no neutral) via selector switch.
- Master & slave switch for 2 & 3 way dimming.
- Covers, plates and buttons are made from UV stabilised polycarbonate to avoid discolouring.
- Bluetooth mesh connectivity with each device acting as a repeater.
- 2 year warranty.
- Soft touch button and dimming control.  
Press for on/off  
Hold for dimming  
Double press for full brightness  
Triple press for a timed fade to off.
- Auto off timer.
- Real time energy use in watts & dollars.
- Automatic schedules inbuilt.
- Power outage recovery.
- Night light on/off and auto dim.
- Min and max dimming levels for increased dimming compatibility without flicker.
- Voice control with your favourite voice assistant.\*

**Plus more features with the latest software version.**  
Visit [www.zimi.life](http://www.zimi.life).

### Specifications

Product Code	Colour	Description
PMPUSWV1GS	White	Powermesh Light Dimmer
PMPUSWV1GSBKS	Black	

- **Line voltage frequency:** 50Hz Nominal
- **Load brightness control range:** 1% to >95% (load dependant)
- **Rated load:** Maximum 1A @ 250V ~ 250W
- **Minimum load:** 2W

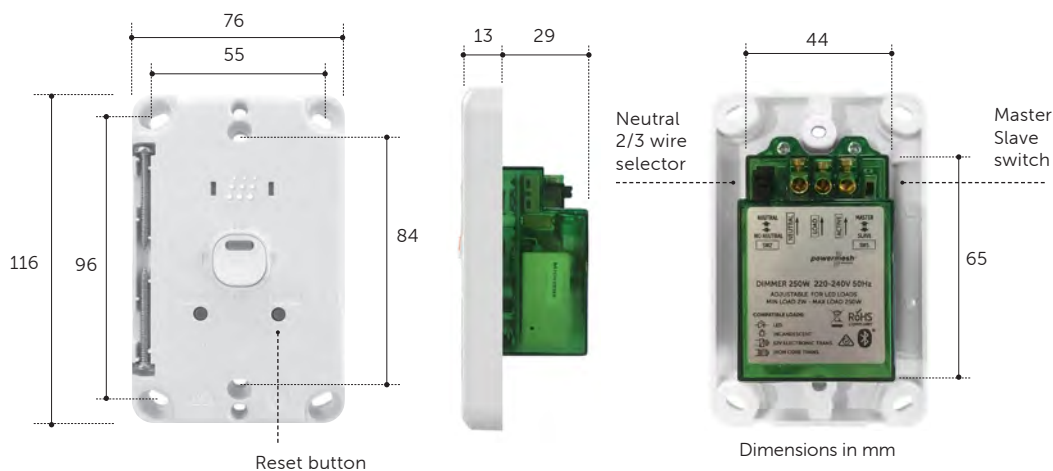

**PMPUSWV1GS**



**PMPUSWV1GSBKS**

**Standards Approval:**  
AS/NZ60669.2.1 & AS/NZS CISPR15

**Certification Number:**  
GMA-504509-EA



### Download Zimi

Scan the code with your phone camera to download.



### Zimi Cloud Connect \*

Control all your Powermesh devices anywhere in the world via your Wi-Fi Internet.



### Compatible load types

- Dimmable LED drivers & lamps
- 12V electronic transformers
- Standard iron core & toroidal transformers
- Incandescent

### Cleaning Guidelines

Ensure that switches are turned off before cleaning. Only clean the surfaces with a damp or dry cloth.

### DO NOT

- x spray anything directly on to electrical switches or power point sockets
- x use cleaning sprays or harsh chemical cleaners
- x use an abrasive cloth
- x wash the cover plates in hot water.

**zimi** 14 Millennium Circuit, Helensvale, QLD 4212 Australia. [www.zimi.life](http://www.zimi.life)

Need help?  
<https://support.zimi.life>

Powermesh products must be installed by a qualified electrician. Zimi requires a compatible (Android, iOS) mobile device, minimum OS requirements are available at [www.zimi.life](http://www.zimi.life). Availability and performance of certain features are service, device and network-dependent and may not be available in all areas; subscription(s) may be required, and additional terms, conditions and/or charges may apply. All features, functionality and other product specifications are subject to change without notice or obligation. Powermesh products are optimised for the use with the Zimi App. The Bluetooth word mark and logos are registered trademarks owned by the Bluetooth SIG, Inc. iOS is a trademark or registered trademark of Cisco Inc. Zimi and Powermesh and their respective logos are registered trademarks of Zimi Ltd. Google and Google Play are trademarks of Google LLC. Amazon, Alexa, and all related logos are trademarks of Amazon.com, Inc. or its affiliates. Apple, the Apple logo, Apple Watch and iPhone are trademarks of Apple Inc., registered in the U.S. and other countries. App Store is a service mark of Apple Inc., registered in the U.S. and other countries. Copyright © 2021 Zimi Ltd. All rights reserved.

# Multi Purpose Switch

## 1 Button



### Data Sheet

#### Features

- Fits standard Australian wall boxes and mounting accessories that use 84mm mounting centres.
- Switch terminals have 4mm bore to suit 1.5mm<sup>2</sup> cable.
- Soft touch button control.
- Neutral connection not required (2 wire); connect neutral if available (3 wire).
- Auto sensing of 3 wire and 2 wire (no neutral mode).
- LED indicator displays on/off state.
- Covers, plates and buttons are made from UV stabilised polycarbonate to avoid discolouring.
- Silverfish antenna technology.
- Bluetooth mesh connectivity with each device acting as a repeater.
- 2 year warranty.
- Real time energy use in watts & dollars.
- Automatic schedules inbuilt.
- Auto off timer (double press to ignore).
- Power outage recovery.
- Night light on/off and auto dim.
- Multi way switching of other Powermesh devices using Behaviour Link.
- Voice control with your favourite voice assistant.\*

**Plus more features with the latest software version.**  
Visit [www.zimi.life](http://www.zimi.life)

#### Specifications

Product Code	Colour	Description	
PMMP51	White	Powermesh Multi Purpose Switch 1 Button	<ul style="list-style-type: none"><li><b>Motor Rating:</b> M40</li><li><b>3 wire with Neutral:</b> 240V~ 5AX maximum</li><li><b>2 wire without Neutral:</b> 240V~ 5A maximum for channel one, suitable load required.</li></ul>
PMMP51BK	Black		

**Always use a Neutral wire where possible.** When operating without a neutral connected, a small amount of power is used via LOAD 1 when switched off. This may in some instances result with lights not completely turning off. **Dimmable** loads might be fixed by increasing to at least 2 lights with a load >10W. **Non-Dimmable** loads may require a bypass/load correction device fitted if the load is insufficient.

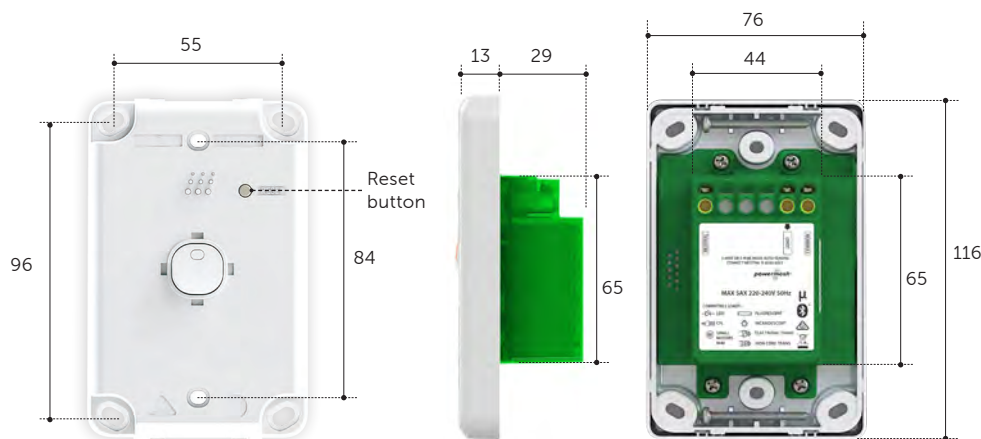

Dimensions in mm

#### Compatible load types\*

LED	Electronic transformers
Incandescent	Standard iron core & toroidal transformers
Fluorescent	Exhaust fans small motors
CFLs	

#### Cleaning Guidelines

Ensure that switches are turned off before cleaning. Only clean the surfaces with a damp or dry cloth.

#### DO NOT

- x spray anything directly on to electrical switches or power point sockets
- x use cleaning sprays or harsh chemical cleaners
- x use an abrasive cloth
- x wash the cover plates in hot water.



PMMP51



PMMP51BK

**Standards Approval:**  
AS/NZ60669.2.1 & AS/NZS CISPR15

**Certification Number:**  
GMA-506936-EA



#### Download Zimi

Scan the code with your phone camera to download.



#### Zimi Cloud Connect \*

Control all your Powermesh devices anywhere in the world via your Wi-Fi Internet.



14 Millennium Circuit, Helensvale,  
QLD 4212 Australia. [www.zimi.life](http://www.zimi.life)

Need help?  
<https://support.zimi.life>

Powermesh products must be installed by a qualified electrician. Zimi requires a compatible (Android, iOS) mobile device, minimum OS requirements are available at [www.zimi.life](http://www.zimi.life). Availability and performance of certain features are service, device and network-dependent and may not be available in all areas; subscription(s) may be required, and additional terms, conditions and/or charges may apply. All features, functionality and other product specifications are subject to change without notice or obligation. Powermesh products are optimised for the use with the Zimi App. The Bluetooth word mark and logos are registered trademarks owned by the Bluetooth SIG, Inc. iOS is a trademark or registered trademark of Cisco Inc. Zimi and Powermesh and their respective logos are registered trademarks of Zimi Ltd. Google and Google Play are trademarks of Google LLC. Amazon, Alexa, and all related logos are trademarks of Amazon.com, Inc. or its affiliates. Apple, the Apple logo, Apple Watch and iPhone are trademarks of Apple Inc., registered in the U.S. and other countries. App Store is a service mark of Apple Inc., registered in the U.S. and other countries. Copyright © 2021 Zimi Ltd. All rights reserved.

# Multi Purpose Switch

## 2 Button



### Data Sheet

#### Features

- Fits standard Australian wall boxes and mounting accessories that use 84mm mounting centres.
- Switch terminals have 4mm bore to suit 1.5mm<sup>2</sup> cable.
- Soft touch button control.
- Neutral connection not required (2 wire); connect neutral if available (3 wire).
- Auto sensing of 3 wire and 2 wire (no neutral mode).
- LED indicator displays on/off state.
- Covers, plates and buttons are made from UV stabilised polycarbonate to avoid discolouring.
- Silverfish antenna technology.
- Bluetooth mesh connectivity with each device acting as a repeater.
- 2 year warranty.
- Real time energy use in watts & dollars.
- Automatic schedules inbuilt.
- Auto off timer (double press to ignore).
- Power outage recovery.
- Night light on/off and auto dim.
- Multi way switching of other Powermesh devices using Behaviour Link.
- Voice control with your favourite voice assistant.\*

**Plus more features with the latest software version.**  
Visit [www.zimi.life](http://www.zimi.life)

#### Specifications

Product Code	Colour	Description
PMMP52	White	Powermesh Multi Purpose Switch
PMMP52BK	Black	2 Button

- Motor Rating:** M40
- 3 wire with Neutral:** 240V~  
5AX max per channel, 10AX total max load.
- 2 wire without Neutral:** 240V~  
5AX max per channel, channel 1 is 5A only.

**Always use a Neutral wire where possible.** When operating without a neutral connected, a small amount of power is used via LOAD 1 when switched off. This may in some instances result with lights not completely turning off. **Dimmable** loads might be fixed by increasing to at least 2 lights with a load >10W. **Non-Dimmable** loads may require a bypass/load correction device fitted if the load is insufficient.

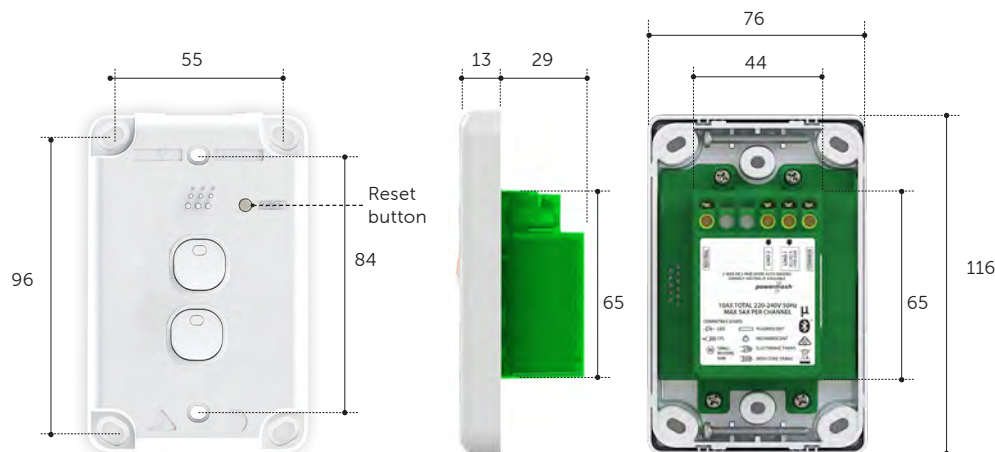

#### Compatible load types\*

LED	Electronic transformers
Incandescent	Standard iron core & toroidal transformers
Fluorescent	Exhaust fans small motors
CFLs	

#### Cleaning Guidelines

Ensure that switches are turned off before cleaning. Only clean the surfaces with a damp or dry cloth.

#### DO NOT

- x spray anything directly on to electrical switches or power point sockets
- x use cleaning sprays or harsh chemical cleaners
- x use an abrasive cloth
- x wash the cover plates in hot water.



**PMMP52**



**PMMP52BK**

**Standards Approval:**  
AS/NZ60669.2.1 & AS/NZS CISPR15

**Certification Number:**  
GMA-506936-EA



#### Download Zimi

Scan the code with your phone camera to download.



#### Zimi Cloud Connect \*

Control all your Powermesh devices anywhere in the world via your Wi-Fi Internet.



14 Millennium Circuit, Helensvale,  
QLD 4212 Australia. [www.zimi.life](http://www.zimi.life)

Need help?  
<https://support.zimi.life>

Powermesh products must be installed by a qualified electrician. Zimi requires a compatible (Android, iOS) mobile device, minimum OS requirements are available at [www.zimi.life](http://www.zimi.life). Availability and performance of certain features are service, device and network-dependent and may not be available in all areas; subscription(s) may be required, and additional terms, conditions and/or charges may apply. All features, functionality and other product specifications are subject to change without notice or obligation. Powermesh products are optimised for the use with the Zimi App. The Bluetooth word mark and logos are registered trademarks owned by the Bluetooth SIG, Inc. iOS is a trademark or registered trademark of Cisco Inc. Zimi and Powermesh and their respective logos are registered trademarks of Zimi Ltd. Google and Google Play are trademarks of Google LLC. Amazon, Alexa, and all related logos are trademarks of Amazon.com, Inc. or its affiliates. Apple, the Apple logo, Apple Watch and iPhone are trademarks of Apple Inc., registered in the U.S. and other countries. App Store is a service mark of Apple Inc., registered in the U.S. and other countries. Copyright © 2021 Zimi Ltd. All rights reserved.



# Multi Purpose Switch

## 3 Button



### Data Sheet

#### Features

- Fits standard Australian wall boxes and mounting accessories that use 84mm mounting centres.
- Switch terminals have 4mm bore to suit 1.5mm<sup>2</sup> cable.
- Soft touch button control.
- Neutral connection not required (2 wire); connect neutral if available (3 wire).
- Auto sensing of 3 wire and 2 wire (no neutral mode).
- LED indicator displays on/off state.
- Covers, plates and buttons are made from UV stabilised polycarbonate to avoid discolouring.
- Silverfish antenna technology.
- Bluetooth mesh connectivity with each device acting as a repeater.
- 2 year warranty.
- Real time energy use in watts & dollars.
- Automatic schedules inbuilt.
- Auto off timer (double press to ignore).
- Power outage recovery.
- Night light on/off and auto dim.
- Multi way switching of other Powermesh devices using Behaviour Link.
- Voice control with your favourite voice assistant.\*

**Plus more features with the latest software version.**  
Visit [www.zimi.life](http://www.zimi.life)

#### Specifications

Product Code	Colour	Description
PMMP53	White	Powermesh Multi Purpose Switch 3 Button
PMMP53BK	Black	

- Motor Rating:** M40
- 3 wire with Neutral:** 240V~  
5AX max per channel, 10AX max load.
- 2 wire without Neutral:** 240V~  
5AX max per channel, channel 1 is 5A only.

**Always use a Neutral wire where possible.** When operating without a neutral connected, a small amount of power is used via LOAD 1 when switched off. This may in some instances result with lights not completely turning off. **Dimmable** loads might be fixed by increasing to at least 2 lights with a load >10W. **Non-Dimmable** loads may require a bypass/load correction device fitted if the load is insufficient.

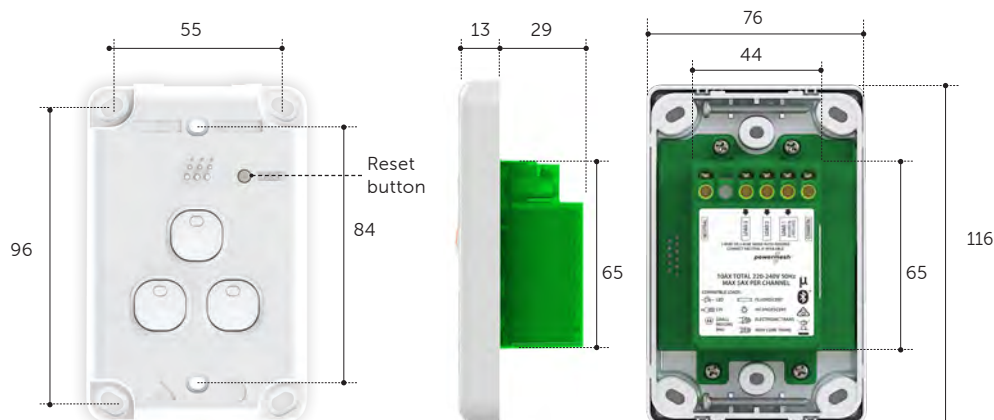

#### Compatible load types\*

LED	Electronic transformers
Incandescent	Standard iron core & toroidal transformers
Fluorescent	Exhaust fans small motors
CFLs	

#### Cleaning Guidelines

Ensure that switches are turned off before cleaning. Only clean the surfaces with a damp or dry cloth.

#### DO NOT

- x spray anything directly on to electrical switches or power point sockets
- x use cleaning sprays or harsh chemical cleaners
- x use an abrasive cloth
- x wash the cover plates in hot water.



**PMMP53**



**PMMP53BK**

**Standards Approval:**  
AS/NZ60669.2.1 & AS/NZS CISPR15

**Certification Number:**  
GMA-506939-EA



#### Download Zimi

Scan the code with your phone camera to download.



#### Zimi Cloud Connect \*

Control all your Powermesh devices anywhere in the world via your Wi-Fi Internet.



**zimi** 14 Millennium Circuit, Helensvale,  
QLD 4212 Australia. [www.zimi.life](http://www.zimi.life)

Need help?  
<https://support.zimi.life>

Powermesh products must be installed by a qualified electrician. Zimi requires a compatible (Android, iOS) mobile device, minimum OS requirements are available at [www.zimi.life](http://www.zimi.life). Availability and performance of certain features are service, device and network-dependent and may not be available in all areas; subscription(s) may be required, and additional terms, conditions and/or charges may apply. All features, functionality and other product specifications are subject to change without notice or obligation. Powermesh products are optimised for the use with the Zimi App. The Bluetooth word mark and logos are registered trademarks owned by the Bluetooth SIG, Inc. iOS is a trademark or registered trademark of Cisco Inc. Zimi and Powermesh and their respective logos are registered trademarks of Zimi Ltd. Google and Google Play are trademarks of Google LLC. Amazon, Alexa, and all related logos are trademarks of Amazon.com, Inc. or its affiliates. Apple, the Apple logo, Apple Watch and iPhone are trademarks of Apple Inc., registered in the U.S. and other countries. App Store is a service mark of Apple Inc., registered in the U.S. and other countries. Copyright © 2021 Zimi Ltd. All rights reserved.

# Multi Purpose Switch

## 4 Button



### Data Sheet

#### Features

- Fits standard Australian wall boxes and mounting accessories that use 84mm mounting centres.
- Switch terminals have 4mm bore to suit 1.5mm<sup>2</sup> cable.
- Soft touch button control.
- Neutral connection not required (2 wire); connect neutral if available (3 wire).
- Auto sensing of 3 wire and 2 wire (no neutral mode).
- LED indicator displays on/off state.
- Covers, plates and buttons are made from UV stabilised polycarbonate to avoid discolouring.
- Silverfish antenna technology.
- 2 year warranty.
- Bluetooth mesh connectivity with each device acting as a repeater.
- Real time energy use in watts & dollars.
- Automatic schedules inbuilt.
- Auto off timer (double press to ignore).
- Power outage recovery.
- Night light on/off and auto dim.
- Multi way switching of other Powermesh devices using Behaviour Link.
- Voice control with your favourite voice assistant.\*

**Plus more features with the latest software version.**  
Visit [www.zimi.life](http://www.zimi.life)

#### Specifications

Product Code	Colour	Description
PMMPS4	White	Powermesh Multi Purpose Switch 4 Button
PMMPS4BK	Black	

- Motor Rating:** M40
- 3 wire with Neutral:** 240V~ 5AX max per channel, 10AX max load.
- 2 wire without Neutral:** 240V~ 5AX max per channel, channel 1 is 5A only.

**Always use a Neutral wire where possible.** When operating without a neutral connected, a small amount of power is used via LOAD 1 when switched off. This may in some instances result with lights not completely turning off. **Dimmable** loads might be fixed by increasing to at least 2 lights with a load >10W. **Non-Dimmable** loads may require a bypass/load correction device fitted if the load is insufficient.

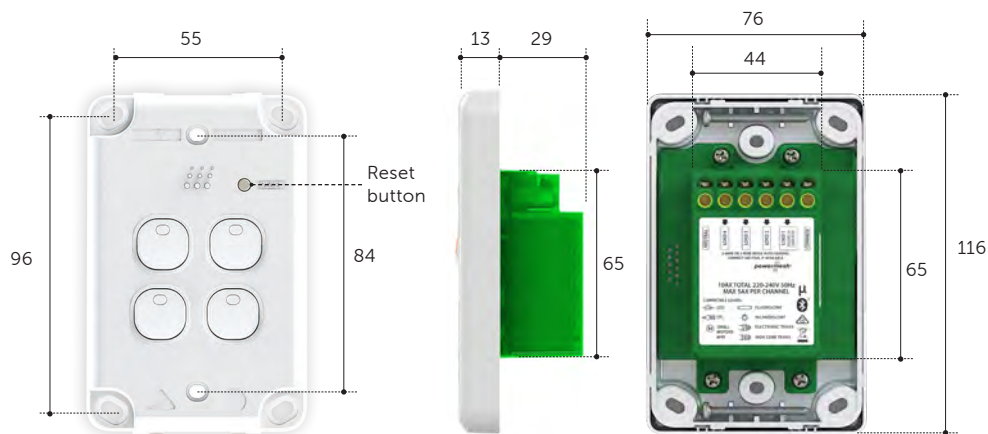

#### Compatible load types\*

LED	Electronic transformers
Incandescent	Standard iron core & toroidal transformers
Fluorescent	Exhaust fans small motors
CFLs	

#### Cleaning Guidelines

Ensure that switches are turned off before cleaning. Only clean the surfaces with a damp or dry cloth.

#### DO NOT

- spray anything directly on to electrical switches or power point sockets
- use cleaning sprays or harsh chemical cleaners
- use an abrasive cloth
- wash the cover plates in hot water.



**PMMPS4**



**PMMPS4BK**

**Standards Approval:**  
AS/NZ60669.2.1 & AS/NZS CISPR15

**Certification Number:**  
GMA-506939-EA



#### Download Zimi

Scan the code with your phone camera to download.



#### Zimi Cloud Connect \*

Control all your Powermesh devices anywhere in the world via your Wi-Fi Internet.



14 Millennium Circuit, Helensvale,  
QLD 4212 Australia. [www.zimi.life](http://www.zimi.life)

Need help?  
<https://support.zimi.life>

Powermesh products must be installed by a qualified electrician. Zimi requires a compatible (Android, iOS) mobile device, minimum OS requirements are available at [www.zimi.life](http://www.zimi.life). Availability and performance of certain features are service, device and network-dependent and may not be available in all areas; subscription(s) may be required, and additional terms, conditions and/or charges may apply. All features, functionality and other product specifications are subject to change without notice or obligation. Powermesh products are optimised for the use with the Zimi App. The Bluetooth word mark and logos are registered trademarks owned by the Bluetooth SIG, Inc. iOS is a trademark or registered trademark of Cisco Inc. Zimi and Powermesh and their respective logos are registered trademarks of Zimi Ltd. Google and Google Play are trademarks of Google LLC. Amazon, Alexa, and all related logos are trademarks of Amazon.com, Inc. or its affiliates. Apple, the Apple logo, Apple Watch and iPhone are trademarks of Apple Inc., registered in the U.S. and other countries. App Store is a service mark of Apple Inc., registered in the U.S. and other countries. Copyright © 2021 Zimi Ltd. All rights reserved.

# Multi Purpose Switch

## 1 Button Horizontal



### Data Sheet

#### Features

- Fits standard Australian wall boxes and mounting accessories that use 84mm mounting centres.
- Switch terminals have 4mm bore to suit 1.5mm<sup>2</sup> cable.
- Soft touch button control.
- Neutral connection not required (2 wire); connect neutral if available (3 wire).
- Auto sensing of 3 wire and 2 wire (no neutral mode).
- LED indicator displays on/off state.
- Covers, plates and buttons are made from UV stabilised polycarbonate to avoid discolouring.
- Silverfish antenna technology.
- 2 year warranty.
- Bluetooth mesh connectivity with each device acting as a repeater.
- Real time energy use in watts & dollars.
- Automatic schedules inbuilt.
- Auto off timer (double press to ignore).
- Power outage recovery.
- Night light on/off and auto dim.
- Multi way switching of other Powermesh devices using Behaviour Link.
- Voice control with your favourite voice assistant.\*

**Plus more features with the latest software version.**  
Visit [www.zimi.life](http://www.zimi.life)

#### Specifications

Product Code	Colour	Description	
PMMP51H	White	Powermesh Multi Purpose Switch 1 Button Horizontal	<ul style="list-style-type: none"> <li><b>Motor Rating:</b> M40</li> <li><b>3 wire with Neutral:</b> 240V~ 5AX maximum</li> <li><b>2 wire without Neutral:</b> 240V~ 5A maximum for channel one, suitable load required.</li> </ul>
PMMP51HBK	Black		

**Always use a Neutral wire where possible.** When operating without a neutral connected, a small amount of power is used via LOAD 1 when switched off. This may in some instances result with lights not completely turning off. **Dimmable** loads might be fixed by increasing to at least 2 lights with a load >10W. **Non-Dimmable** loads may require a bypass/load correction device fitted if the load is insufficient.

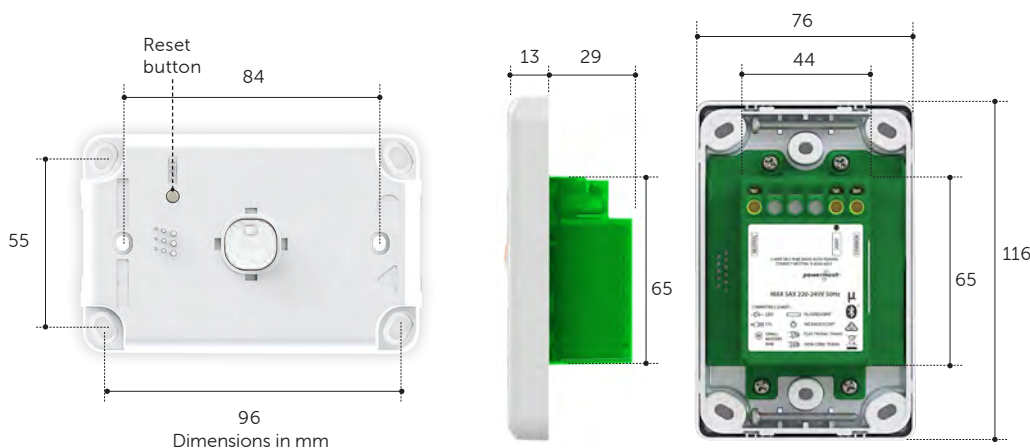

#### Compatible load types\*

LED	Electronic transformers
Incandescent	Standard iron core & toroidal transformers
Fluorescent	Exhaust fans small motors
CFLs	

#### Cleaning Guidelines

Ensure that switches are turned off before cleaning. Only clean the surfaces with a damp or dry cloth.

#### DO NOT

- x spray anything directly on to electrical switches or power point sockets
- x use cleaning sprays or harsh chemical cleaners
- x use an abrasive cloth
- x wash the cover plates in hot water.



**PMMP51H**



**PMMP51HBK**

**Standards Approval:**  
AS/NZ60669.2.1 & AS/NZS CISPR15

**Certification Number:**  
GMA-506936-EA



#### Download Zimi

Scan the code with your phone camera to download.



#### Zimi Cloud Connect \*

Control all your Powermesh devices anywhere in the world via your Wi-Fi Internet.



**zimi** 14 Millennium Circuit, Helensvale,  
QLD 4212 Australia. [www.zimi.life](http://www.zimi.life)

Need help?  
<https://support.zimi.life>

Powermesh products must be installed by a qualified electrician. Zimi requires a compatible (Android, iOS) mobile device, minimum OS requirements are available at [www.zimi.life](http://www.zimi.life). Availability and performance of certain features are service, device and network-dependent and may not be available in all areas; subscription(s) may be required, and additional terms, conditions and/or charges may apply. All features, functionality and other product specifications are subject to change without notice or obligation. Powermesh products are optimised for the use with the Zimi App. The Bluetooth word mark and logos are registered trademarks owned by the Bluetooth SIG, Inc. iOS is a trademark or registered trademark of Cisco Inc. Zimi and Powermesh and their respective logos are registered trademarks of Zimi Ltd. Google and Google Play are trademarks of Google LLC. Amazon, Alexa, and all related logos are trademarks of Amazon.com, Inc. or its affiliates. Apple, the Apple logo, Apple Watch and iPhone are trademarks of Apple Inc., registered in the U.S. and other countries. App Store is a service mark of Apple Inc., registered in the U.S. and other countries. Copyright © 2021 Zimi Ltd. All rights reserved.



# Multi Purpose Switch

## 2 Button Horizontal



### Data Sheet

#### Features

- Fits standard Australian wall boxes and mounting accessories that use 84mm mounting centres.
- Switch terminals have 4mm bore to suit 1.5mm<sup>2</sup> cable.
- Soft touch button control.
- Neutral connection not required (2 wire); connect neutral if available (3 wire).
- Auto sensing of 3 wire and 2 wire (no neutral mode).
- LED indicator displays on/off state.
- Covers, plates and buttons are made from UV stabilised polycarbonate to avoid discolouring.
- Silverfish antenna technology.
- 2 year warranty.
- Bluetooth mesh connectivity with each device acting as a repeater.
- Real time energy use in watts & dollars.
- Automatic schedules inbuilt.
- Auto off timer (double press to ignore).
- Power outage recovery.
- Night light on/off and auto dim.
- Multi way switching of other Powermesh devices using Behaviour Link.
- Voice control with your favourite voice assistant.\*

**Plus more features with the latest software version.**  
Visit [www.zimi.life](http://www.zimi.life)

#### Specifications

Product Code	Colour	Description
PMMP2H	White	Powermesh Multi Purpose Switch
PMMP2HBK	Black	2 Button Horizontal

**Always use a Neutral wire where possible.** When operating without a neutral connected, a small amount of power is used via LOAD 1 when switched off. This may in some instances result with lights not completely turning off. **Dimmable** loads might be fixed by increasing to at least 2 lights with a load >10W. **Non-Dimmable** loads may require a bypass/load correction device fitted if the load is insufficient.

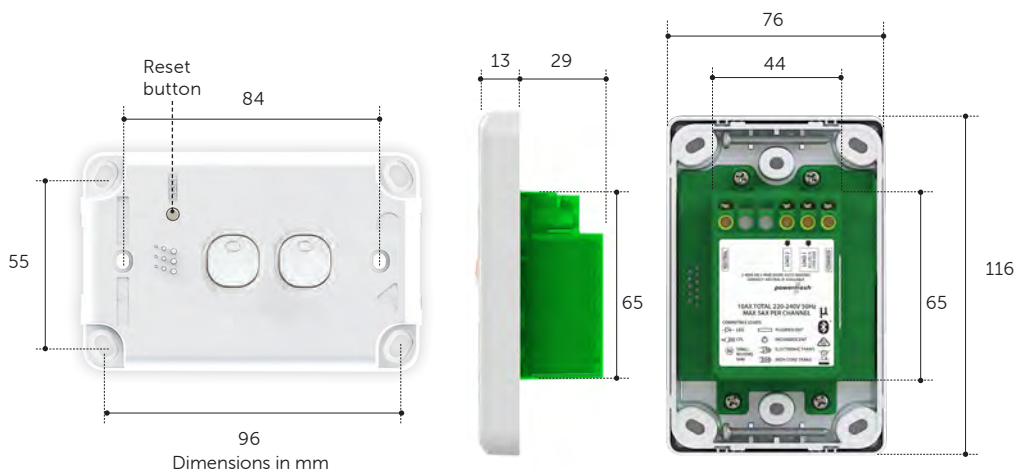

#### Compatible load types\*

	LED		Electronic transformers
	Incandescent		Standard iron core & toroidal transformers
	Fluorescent		Exhaust fans small motors
	CFLs		

#### Cleaning Guidelines

Ensure that switches are turned off before cleaning. Only clean the surfaces with a damp or dry cloth.

#### DO NOT

- x spray anything directly on to electrical switches or power point sockets
- x use cleaning sprays or harsh chemical cleaners
- x use an abrasive cloth
- x wash the cover plates in hot water.



**PMMP2H**



**PMMP2HBK**

**Standards Approval:**  
AS/NZ60669.2.1 & AS/NZS CISPR15

**Certification Number:**  
GMA-506936-EA



#### Download Zimi

Scan the code with your phone camera to download.



#### Zimi Cloud Connect \*

Control all your Powermesh devices anywhere in the world via your Wi-Fi Internet.



**zimi** 14 Millennium Circuit, Helensvale, QLD 4212 Australia. [www.zimi.life](http://www.zimi.life)

Need help?  
<https://support.zimi.life>

Powermesh products must be installed by a qualified electrician. Zimi requires a compatible (Android, iOS) mobile device, minimum OS requirements are available at [www.zimi.life](http://www.zimi.life). Availability and performance of certain features are service, device and network-dependent and may not be available in all areas; subscription(s) may be required, and additional terms, conditions and/or charges may apply. All features, functionality and other product specifications are subject to change without notice or obligation. Powermesh products are optimised for the use with the Zimi App. The Bluetooth word mark and logos are registered trademarks owned by the Bluetooth SIG, Inc. iOS is a trademark or registered trademark of Cisco Inc. Zimi and Powermesh and their respective logos are registered trademarks of Zimi Ltd. Google and Google Play are trademarks of Google LLC. Amazon, Alexa, and all related logos are trademarks of Amazon.com, Inc. or its affiliates. Apple, the Apple logo, Apple Watch and iPhone are trademarks of Apple Inc., registered in the U.S. and other countries. App Store is a service mark of Apple Inc., registered in the U.S. and other countries. Copyright © 2021 Zimi Ltd. All rights reserved.

# Multi Purpose Switch

## 4 Button Horizontal



### Data Sheet

#### Features

- Fits standard Australian wall boxes and mounting accessories that use 84mm mounting centres.
- Switch terminals have 4mm bore to suit 1.5mm<sup>2</sup> cable.
- Soft touch button control.
- Neutral connection not required (2 wire); connect neutral if available (3 wire).
- Auto sensing of 3 wire and 2 wire (no neutral mode).
- LED indicator displays on/off state.
- Covers, plates and buttons are made from UV stabilised polycarbonate to avoid discolouring.
- Silverfish antenna technology.
- 2 year warranty.
- Bluetooth mesh connectivity with each device acting as a repeater.
- Real time energy use in watts & dollars.
- Automatic schedules inbuilt.
- Auto off timer (double press to ignore).
- Power outage recovery.
- Night light on/off and auto dim.
- Multi way switching of other Powermesh devices using Behaviour Link.
- Voice control with your favourite voice assistant.\*

**Plus more features with the latest software version.**  
Visit [www.zimi.life](http://www.zimi.life)

#### Specifications

Product Code	Colour	Description	
PMMP54H	White	Powermesh Multi Purpose Switch	<ul style="list-style-type: none"> <li><b>Motor Rating:</b> M40</li> <li><b>3 wire with Neutral:</b> 240V~ 5AX max per channel, 10AX max load.</li> <li><b>2 wire without Neutral:</b> 240V~ 5AX max per channel, channel 1 is 5A only.</li> </ul>
PMMP54HBK	Black	4 Button Horizontal	

**Always use a Neutral wire where possible.** When operating without a neutral connected, a small amount of power is used via LOAD 1 when switched off. This may in some instances result with lights not completely turning off. **Dimmable** loads might be fixed by increasing to at least 2 lights with a load >10W. **Non-Dimmable** loads may require a bypass/load correction device fitted if the load is insufficient.

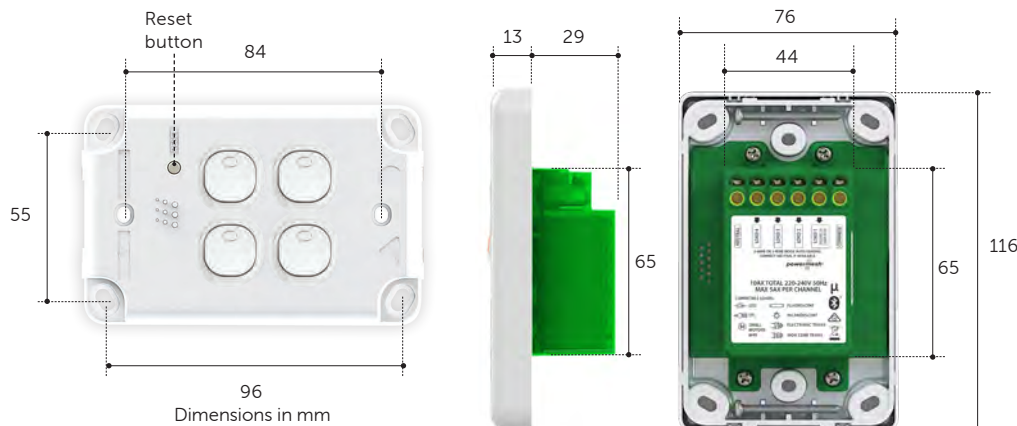

#### Compatible load types\*

LED	Electronic transformers
Incandescent	Standard iron core & toroidal transformers
Fluorescent	Exhaust fans small motors
CFLs	

#### Cleaning Guidelines

Ensure that switches are turned off before cleaning. Only clean the surfaces with a damp or dry cloth.

#### DO NOT

- spray anything directly on to electrical switches or power point sockets
- use cleaning sprays or harsh chemical cleaners
- use an abrasive cloth
- wash the cover plates in hot water.



**PMMP54H**



**PMMP54HBK**

**Standards Approval:**  
AS/NZ60669.2.1 & AS/NZS CISPR15

**Certification Number:**  
GMA-506936-EA



#### Download Zimi

Scan the code with your phone camera to download.



#### Zimi Cloud Connect \*

Control all your Powermesh devices anywhere in the world via your Wi-Fi Internet.



**zimi** 14 Millennium Circuit, Helensvale,  
QLD 4212 Australia. [www.zimi.life](http://www.zimi.life)

Need help?  
<https://support.zimi.life>

Powermesh products must be installed by a qualified electrician. Zimi requires a compatible (Android, iOS) mobile device, minimum OS requirements are available at [www.zimi.life](http://www.zimi.life). Availability and performance of certain features are service, device and network-dependent and may not be available in all areas; subscription(s) may be required, and additional terms, conditions and/or charges may apply. All features, functionality and other product specifications are subject to change without notice or obligation. Powermesh products are optimised for the use with the Zimi App. The Bluetooth word mark and logos are registered trademarks owned by the Bluetooth SIG, Inc. iOS is a trademark or registered trademark of Cisco Inc. Zimi and Powermesh and their respective logos are registered trademarks of Zimi Ltd. Google and Google Play are trademarks of Google LLC. Amazon, Alexa, and all related logos are trademarks of Amazon.com, Inc. or its affiliates. Apple, the Apple logo, Apple Watch and iPhone are trademarks of Apple Inc., registered in the U.S. and other countries. App Store is a service mark of Apple Inc., registered in the U.S. and other countries. Copyright © 2021 Zimi Ltd. All rights reserved.

# Zimi Cloud Connect

## Data Sheet

### Features

- Connects your Powermesh network to the Internet and provides more functionality of all Zimi devices.
- Colour LED status indicator.
- 5V DC - 500mA plug pack included.
- Silverfish antenna technology.
- Bluetooth mesh connectivity with each device acting as a repeater.
- 2 year warranty.
- Provides Zimi app access to Powermesh devices anywhere in world via Wi-Fi Internet.
- Enables energy use history
- Allows voice control of your Powermesh devices with your favourite voice assistant.

**Plus more features with the latest software version.  
Visit [www.zimi.life](http://www.zimi.life)**

### Specifications

Product Code	Colour	Description	Power	Wi-Fi Connectivity
PMZCLOUDV1	White	Zimi Cloud Connect	5V DC - 500mA plug pack included	2.4GHz



**PMZCLOUDV1**

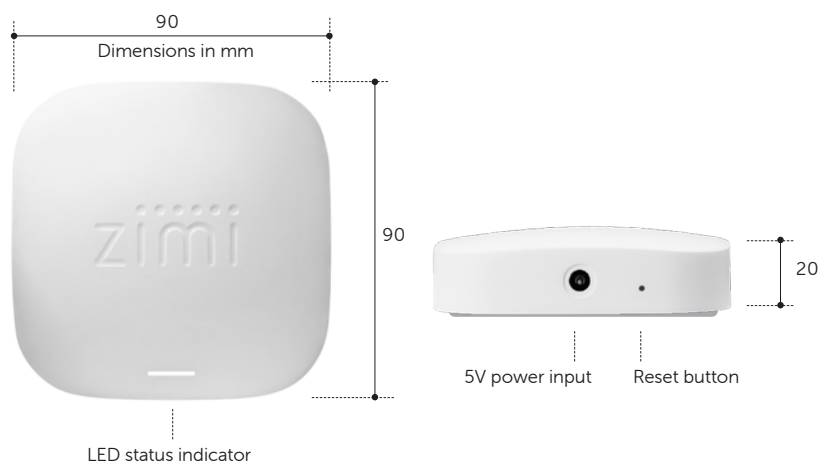

14 Millennium Circuit, Helensvale,  
QLD 4212 Australia. [www.zimi.life](http://www.zimi.life)

Need help?  
<https://support.zimi.life>

### Download Zimi

Scan the code with  
your phone camera  
to download.



Powermesh products must be installed by a qualified electrician. Zimi requires a compatible (Android, iOS) mobile device, minimum OS requirements are available at [www.zimi.life](http://www.zimi.life). Availability and performance of certain features are service, device and network-dependent and may not be available in all areas; subscription(s) may be required, and additional terms, conditions and/or charges may apply. All features, functionality and other product specifications are subject to change without notice or obligation. Powermesh products are optimised for the use with the Zimi App. The Bluetooth word mark and logos are registered trademarks owned by the Bluetooth SIG, Inc. iOS is a trademark or registered trademark of Cisco Inc. Zimi and Powermesh and their respective logos are registered trademarks of Zimi Ltd. Google and Google Play are trademarks of Google LLC. Amazon, Alexa, and all related logos are trademarks of Amazon.com, Inc. or its affiliates. Apple, the Apple logo, Apple Watch and iPhone are trademarks of Apple Inc., registered in the U.S. and other countries. App Store is a service mark of Apple Inc., registered in the U.S. and other countries. Copyright © 2021 Zimi Ltd. All rights reserved.

PMZCLOUDV1 / Revision 1.0 / August 2021

# Garage Door Controller

## with Door Sensor



### Data Sheet

#### Features

- Works with existing motors using the push button terminals. \*\*
- Door Sensor supports roller, sectional and tilt doors.
- Controller supports up to 2 doors (additional sensor required).
- Monitors the garage temperature and humidity.
- Quick connector for easy installation.
- Power Plug Pack, Door Sensor and battery included.
- Voice control with your favourite voice assistant.\*
- Silverfish antenna technology.
- 2 year warranty.

**Plus more features with the latest software version.**  
Visit [www.zimi.life](http://www.zimi.life)

#### PMGCK Specifications

Product Code	Description	Communication	
PMGK	Powermesh Garage Door Controller	Bluetooth®	<ul style="list-style-type: none"> <li>• <b>Power:</b> 24V DC &gt;500mA plug pack</li> <li>• <b>Outputs:</b> 2 x dry connect relays for motor/bell press connection.</li> <li>• <b>Inputs:</b> 2 x Photo Eye Beams (PEB) Refer to the compatibility list.</li> </ul>
PMGS	Powermesh Garage Door Sensor	Bluetooth®	<ul style="list-style-type: none"> <li>• <b>Battery:</b> CR2450</li> <li>• <b>IP rating:</b> IP66.</li> </ul>



**PMGK**

Powermesh Garage Door Controller



**PMGS**

Powermesh Garage Door Sensor



**Garage door motor compatibility \*\***

Scan the code to download the User Manual.



**PMGCK**

Powermesh Garage Door Controller and Sensor Kit.

#### Contains

- 1 x Garage Door Controller
- 1 x Garage Door Sensor
- 1 x 24V DC plug pack
- 1 x CR2459 battery



#### Download Zimi

Scan the code with your phone camera to download.



#### Zimi Cloud Connect \*

Control all your Powermesh devices anywhere in the world via your Wi-Fi Internet.



14 Millennium Circuit, Helensvale,  
QLD 4212 Australia. [www.zimi.life](http://www.zimi.life)

Need help?  
<https://support.zimi.life>

Powermesh products must be installed by a qualified electrician. Zimi requires a compatible (Android, iOS) mobile device, minimum OS requirements are available at [www.zimi.life](http://www.zimi.life). Availability and performance of certain features are service, device and network-dependent and may not be available in all areas; subscription(s) may be required, and additional terms, conditions and/or charges may apply. All features, functionality and other product specifications are subject to change without notice or obligation. Powermesh products are optimised for the use with the Zimi App. The Bluetooth word mark and logos are registered trademarks owned by the Bluetooth SIG, Inc. iOS is a trademark or registered trademark of Cisco Inc. Zimi and Powermesh and their respective logos are registered trademarks of Zimi Ltd. Google and Google Play are trademarks of Google LLC. Amazon, Alexa, and all related logos are trademarks of Amazon.com, Inc. or its affiliates. Apple, the Apple logo, Apple Watch and iPhone are trademarks of Apple Inc., registered in the U.S. and other countries. App Store is a service mark of Apple Inc., registered in the U.S. and other countries. Copyright © 2021 Zimi Ltd. All rights reserved.